

SECTION A-A

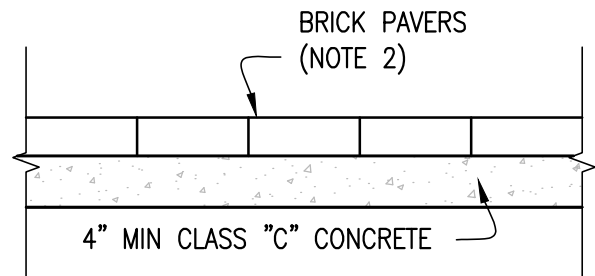

SECTION B-B

B/C = BACK OF CURB

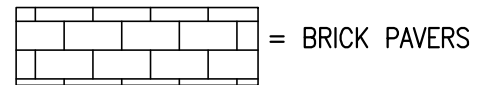

NOTES:

1. NO PAVERS ARE PERMITTED WITHIN THE SIDEWALK.
2. PAVERS ARE ASSUMED TO HAVE A THICKNESS OF 3"±
3. PROVIDE A 1' MIN. WIDTH BORDER USING CLASS "C" CONCRETE.



Chris E. Bauserman, P.E., P.S.
Delaware County Engineer

APPROVED 2010/01/04

REVISED 2021/08/09

STANDARD CONSTRUCTION DRAWING

RESIDENTIAL DRIVE APPROACH
FOR CURB & GUTTER STREET
(BRICK PAVERS)

sheet 1 of 1 DCED-R2201B