

SECTION A-A

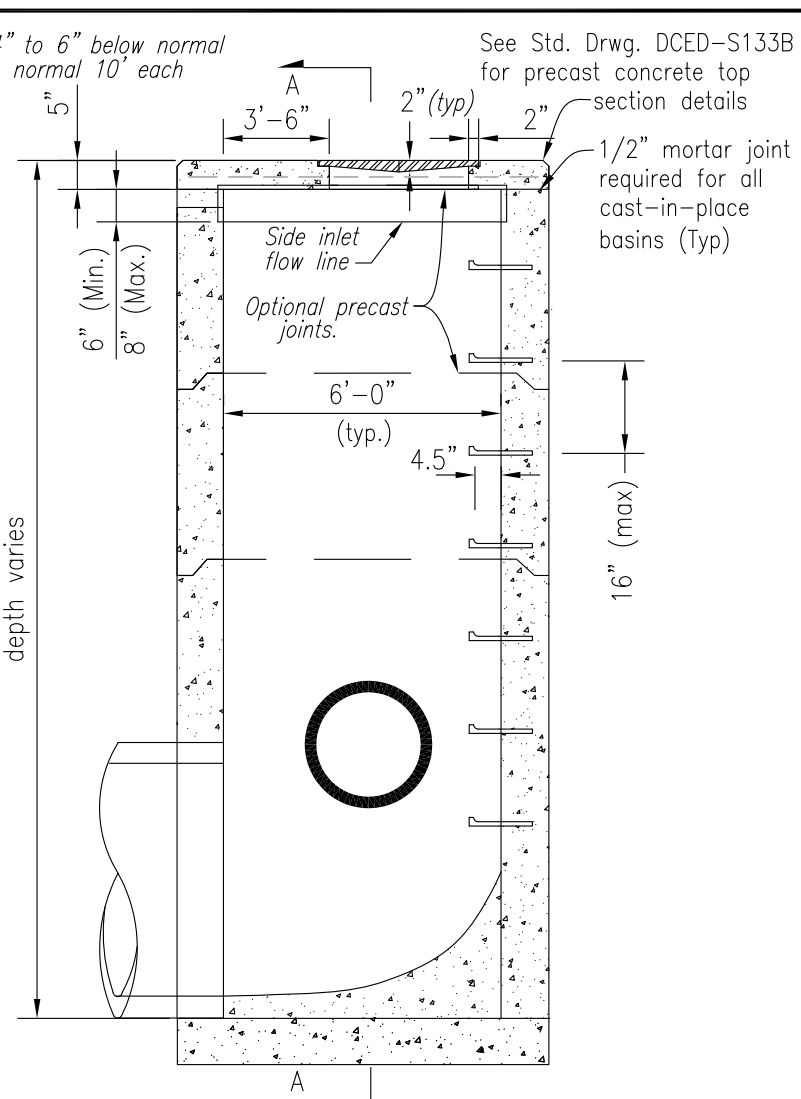

SECTION B-B

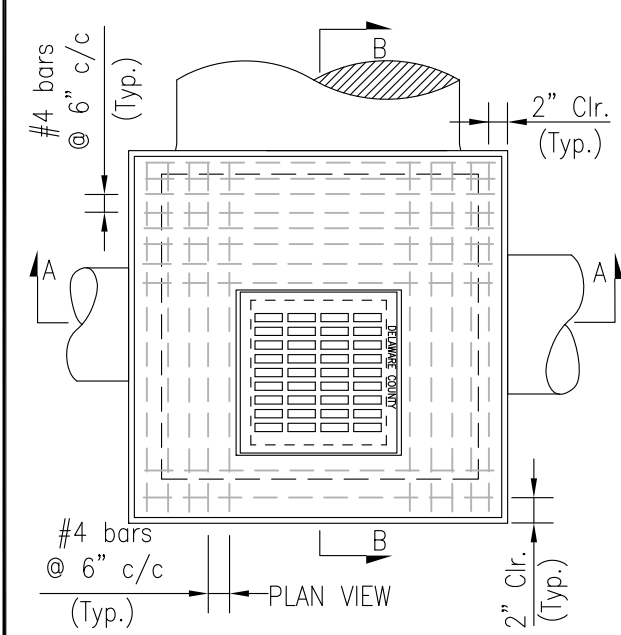

PLAN VIEW

**GRATING** The design shall comply with DCED-S139. Minimum weight: 120 pounds.  
**BRICK**, concrete block or cast-in-place walls shall have a nominal thickness of 8". Pre-cast walls shall have a minimum thickness of 6" and be reinforced sufficiently to permit shipping & handling without damage.  
**Cast-in-place** shall be Class C. Materials other than concrete may only be used with prior written approval of the County Engineer. Wall thickness shall be 8" nominal and plastered on the outside with 1/2" coat of lime cement mortar. All pre-cast concrete shall meet the requirements of 706.13 with 6(±2%) air void content in the hardened concrete and be marked with the catch basin number.  
**REINFORCING** in the top to be #4 epoxy coated bars 6" c/c. For CB 6x6, use 20 bars as shown in detail.  
**OPENINGS** for pipes shall be O.D. +2" when prefabricated or field cut. **LOCATION** and elevation when given on the plans is top center of the grate. When side openings are provided, elevation shall be the flow line of the side inlet.  
**SIDE INLETS** shall be provided only when specified on the plans. In no case shall window opening exceed 8" in height.  
**STEPS** shall be provided on all CB 6x6 structures and shall meet the requirements of DCED-S119.  
**OUTLET PIPE SIZE** of CB 6x6 shall be 54" min. to 60" max.  
**BEDDING** shall conform to Item 901.

CHRIS E. BAUSERMAN, P.E., P.S.  
 Delaware County Engineer  
 Delaware County Engineer  
 APPROVED 1-22-2008  
 REVISED 1-04-2010

STANDARD CONSTRUCTION DRAWING  
 CATCH BASIN  
 6 x 6  
 WITH SIDE INLET AND  
 2 X 2 GRATE

DELAWARE COUNTY ENGINEER'S OFFICE  
 50 Channing Street  
 Delaware, Ohio 43015  
 PHONE: (740)833-2400 FAX: (740)833-2399  
 www.co.delaware.oh.us  
 Drawn KS sheet 6 FILE NO.  
 Checked EM of 6 DCED-S133F